

Approximate Gross Internal Area = 94.7 sq m / 1019 sq ft
Loft Space = 51.3 sq m / 552 sq ft
Total = 146 sq m / 1571 sq ft

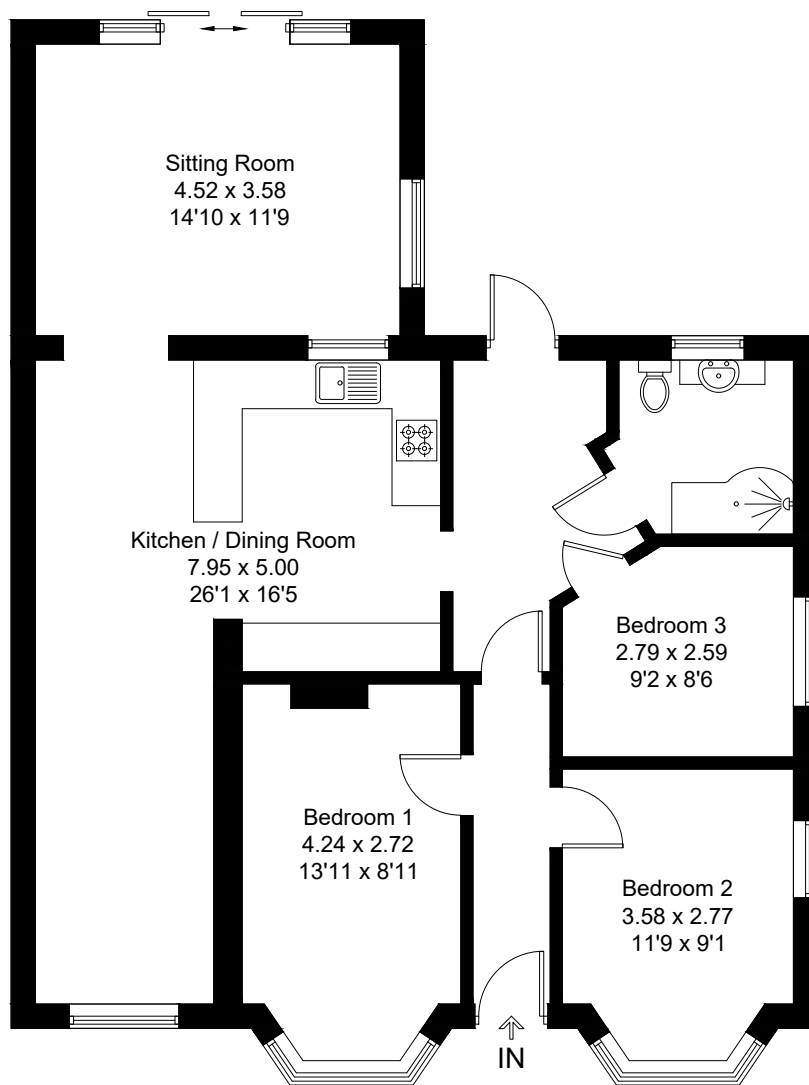

Ground Floor

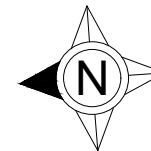
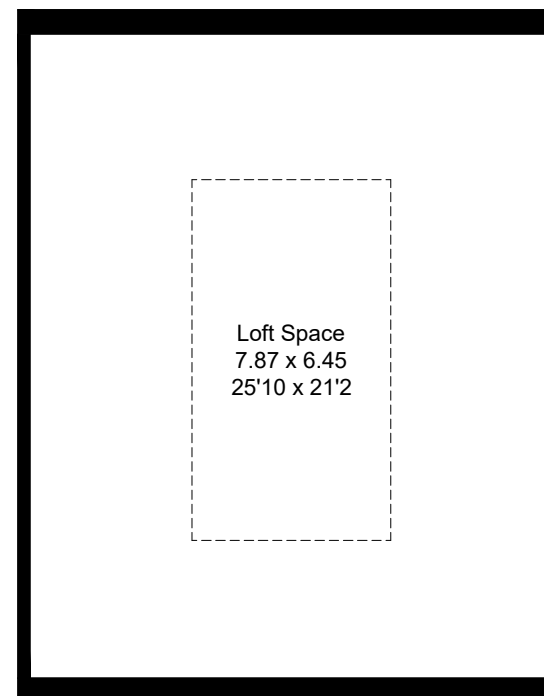

Loft Space

Created by **BAY TREE ESTATES** - Telephone **01243 850451**.

These plans are for representation purposes only as defined by RICS - Code of Measuring Practice. Not to scale.(ID744902)