

Approximate Gross Internal Area = 117.4 sq m / 1264 sq ft
Garage = 7.7 sq m / 83 sq ft
Total = 125.1 sq m / 1347 sq ft

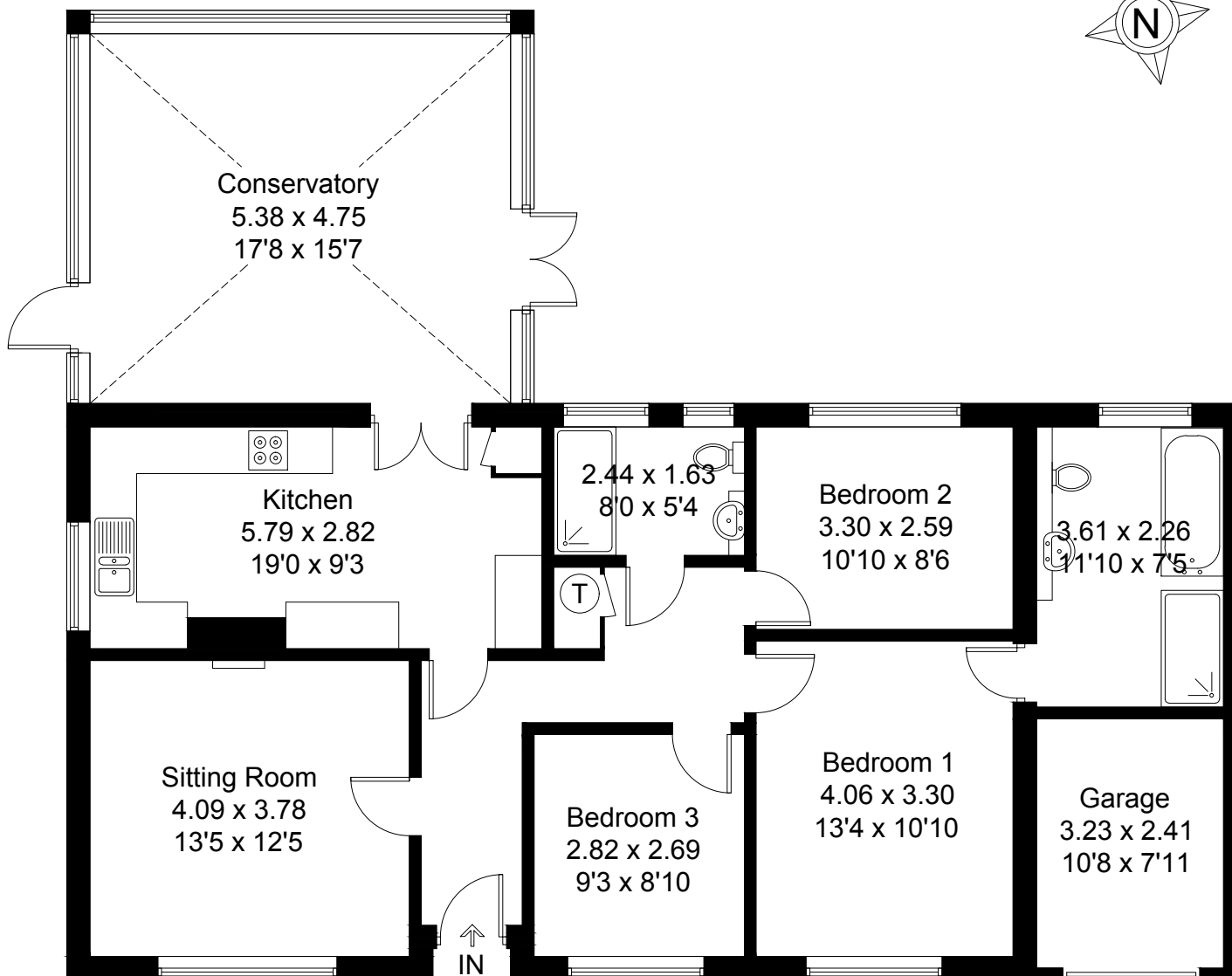
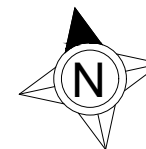

Ground Floor

Created by **BAY TREE ESTATES - Telephone 01243 850451.**

These plans are for representation purposes only as defined by RICS - Code of Measuring Practice. Not to scale.(ID435489)