

Approximate Gross Internal Area = 103.2 sq m / 1111 sq ft  
Garage = 12.9 sq m / 139 sq ft  
Total = 116.1 sq m / 1250 sq ft

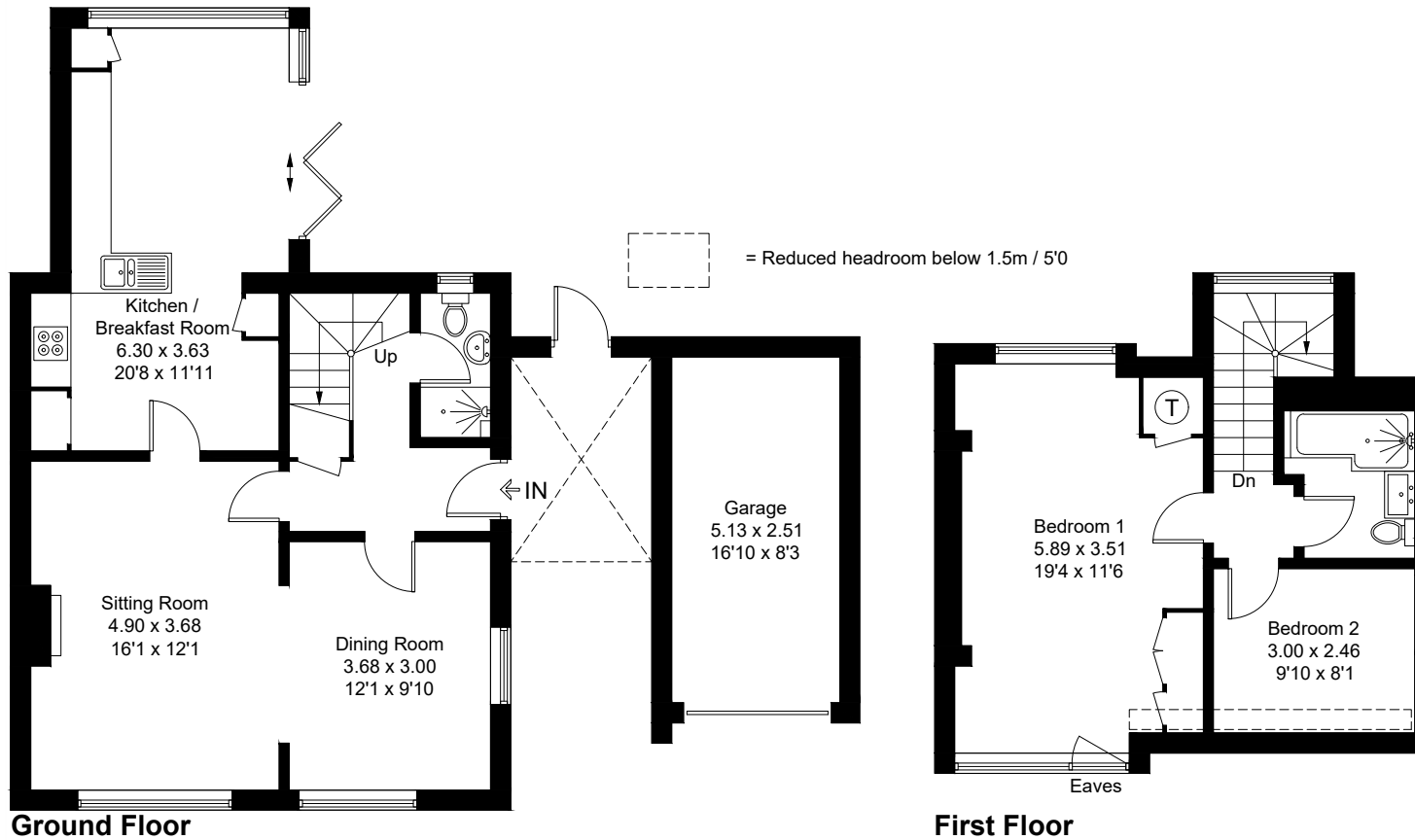
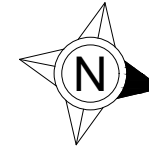

Created by **BAY TREE ESTATES - Telephone 01243 850451.**

These plans are for representation purposes only as defined by RICS - Code of Measuring Practice. Not to scale.(ID1292164)