

Approximate Gross Internal Area = 58.7 sq m / 632 sq ft
Garage = 13.9 sq m / 150 sq ft
Total = 72.6 sq m / 782 sq ft

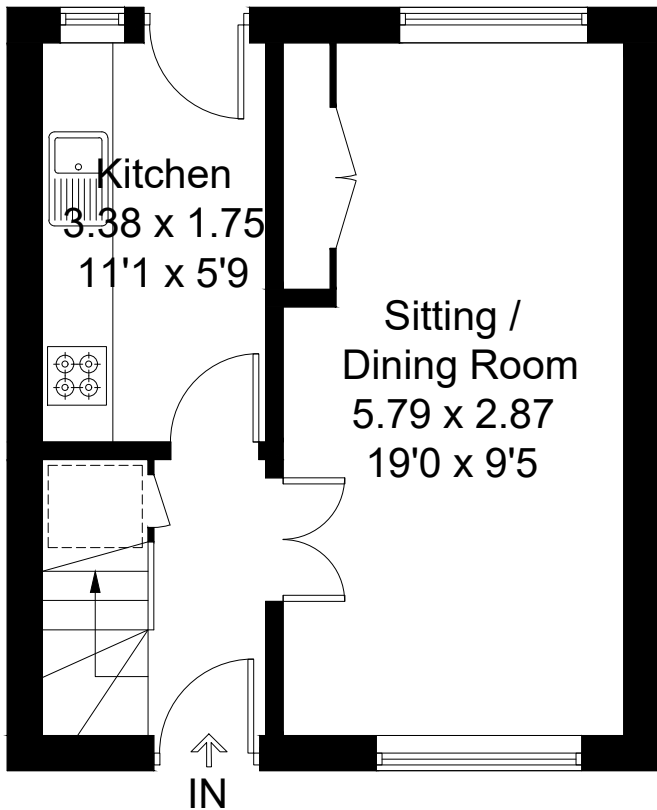

= Reduced headroom below 1.5m / 5'0



Ground Floor

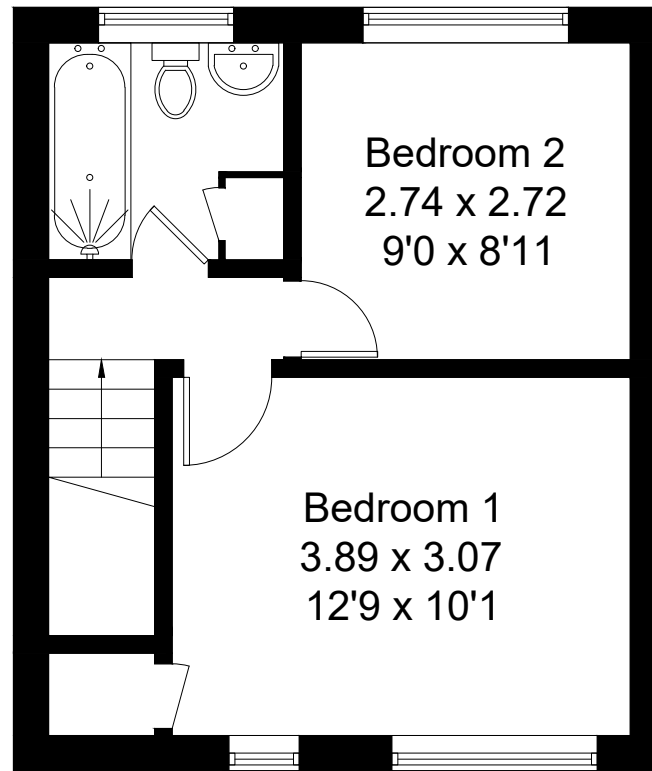

First Floor

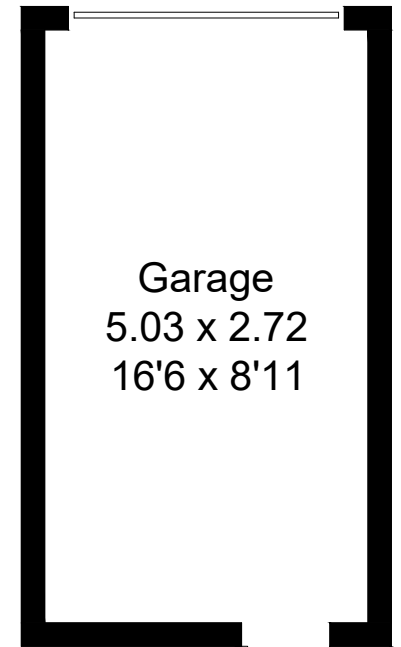

(Not Shown In Actual Location / Orientation)

Created by **BAY TREE ESTATES - Telephone 01243 850451.**

These plans are for representation purposes only as defined by RICS - Code of Measuring Practice. Not to scale.(ID575778)