

Approximate Gross Internal Area = 119.6 sq m / 1287 sq ft  
Garage = 14.0 sq m / 151 sq ft  
Total = 133.6 sq m / 1438 sq ft

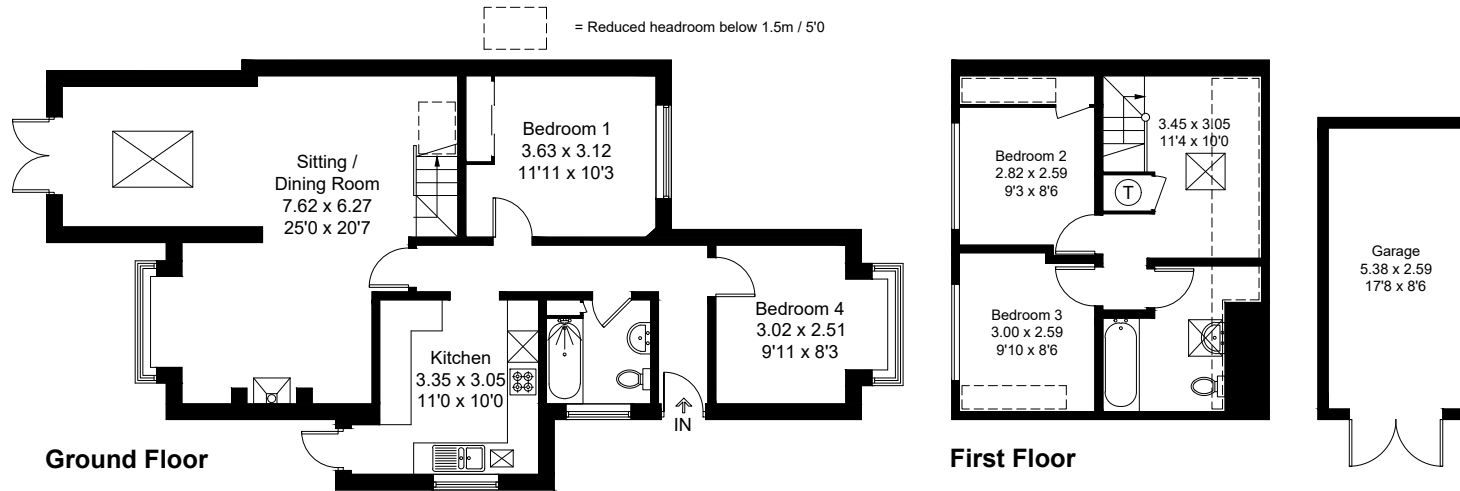

Created by BAY TREE ESTATES - Telephone 01243 850451.

These plans are for representation purposes only as defined by RICS - Code of Measuring Practice. Not to scale.(ID736846)